



Quik Stage Inc.
2121 107th Lane NE
Blaine, MN 55449

763-783-7373 Phone
1-877-783-7373 Toll Free
763-783-7366 Fax

Congratulations on the purchase of your quality portable staging system and/or stage accessories from Quik Stage. The following are detailed instructions to assist you in the set-up and assembly of your new staging and related components. Our engineer has designed every component to be assembled with ease and with a minimal amount of labor and tools. Our first and foremost concern is for the safety of anyone working with or using our products, so please take extra time to make sure that the staging system has been assembled correctly before using. **If at anytime you do not understand these instructions or are having difficulty assembling the stage or accessories, you need to contact Quik Stage for immediate assistance toll free 1-877-783-7373 or 763-783-7373.**

Please Read Carefully Before Proceeding:

The equipment described herein is intended to be used in a commercial application and you the buyer agree to operate and maintain the equipment for its intended use in a professional and competent manor as per Quik Stage instructions and recommendations. You are responsible for following applicable governmental standards and good commercial practices using professional and competent mechanics and/or assemblers. If at any time, and for any reason, the staging and related accessories cannot be adequately and safely used for its intended use, the buyer agrees not to use the equipment until proper repairs or corrections are made. **Quik Stage assumes or accepts no responsibility for any damage or failure to any of our stage components or injuries to person or persons due to improper installation or maintenance.**

In the unlikely event any of the portable stage or staging accessories arrived damaged, do not attempt installation and contact Quik Stage immediately.

1-877-783-7373 Toll Free
612-868-4447 Cell Jim Feneis
612-968-6789 Cell Chris Feneis

Quik Stage Guardrail Systems

Carefully unpack and inspecting your Quik Stage Guardrails.

Your Quik Stage guardrail system is pre-assembled at our factory and is ready to install on your Quik Stage staging or riser system.

After taking inventory of the shipment, inspect the parts or components for any damages that may have occurred during shipping. **In the unlikely event damage has occurred during the shipping process, do not attempt to install the damaged component. Contact Quik Stage at 1-877-783-7373 or 1-763-783-7373 immediately for assistance. If there is difficulty assembling any component of the portable staging system, again, please contact Quik Stage immediately.**

Guardrails are recommended for 32-inch or higher stage heights. **It is your responsibility to know your stage or local codes as to where guardrails are required.** Installation of a guardrail typically takes two people, so make sure there is enough help before proceeding

Install legs to existing stage deck and set up staging in desired location.

Begin install by locating provided hardware bag (See Fig. 1)

Fig. 1



Guardrail Hardware



(2) 3/8 x 16 x 3 Bolts
A



(2) Wingnuts
B

After locating hardware bag, remove (2) hex head bolts and nuts indicated from staging deck, (See fig. 2 & 3)

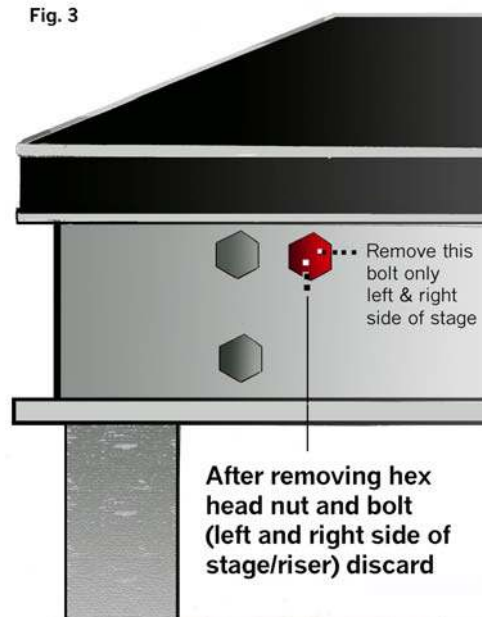
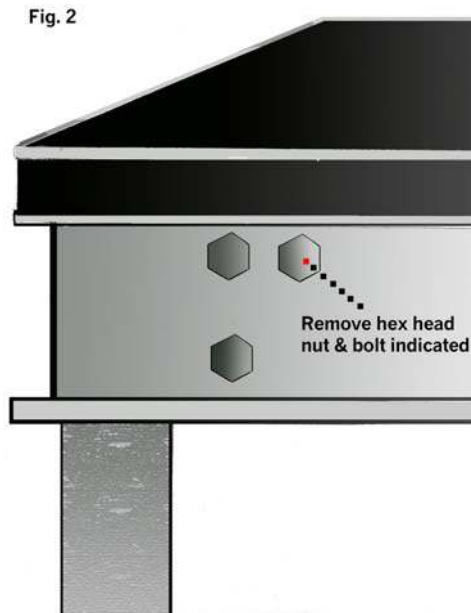

After removing hex head nuts and bolts, gently lift guard rail system on to staging deck surface aligning bottom guard rail cross brace flush with staging deck surface, allowing center brace tabs to lock into bottom frame rail of staging deck, be sure leg brackets (both left and right) are secured to leg. You may have to move leg slightly left, right, forward or back. (See fig. 4 & 5)

(NOTE: Center brace is only present on Guardrail Model #'s QS6GR & QS8GR)

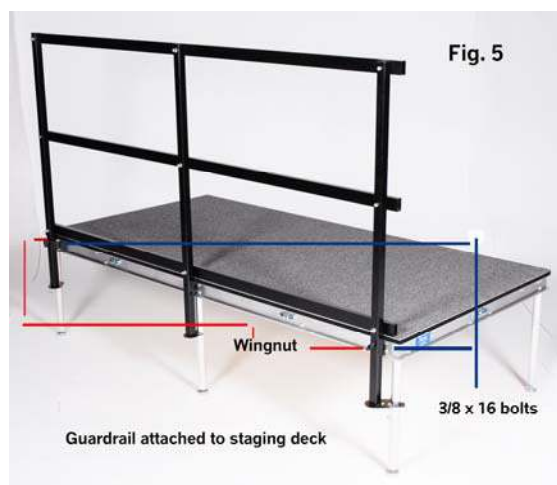

Align bolt holes on left and right guardrail uprights, with bolt holes on staging deck. Insert long bolt (3/8 x 16 x 3) through staging deck and guardrail upright (bolt head on inside of staging deck) Tighten with provided wingnut. Repeat for both left and right sides. (see Fig. 6 and 7)

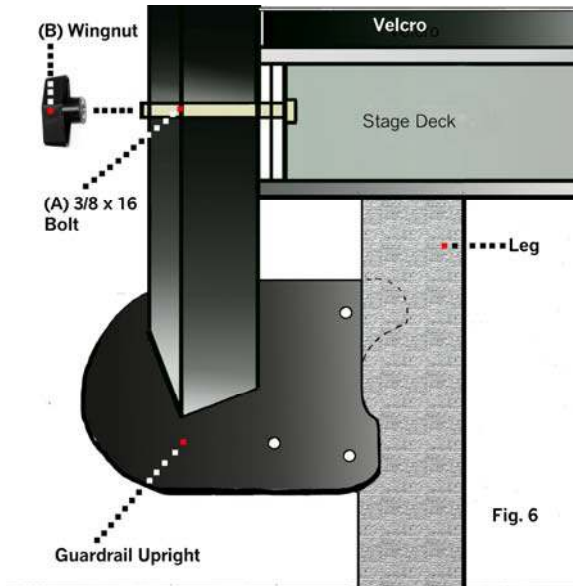

Your Quik Stage guardrail system is now ready for use.

Picture of installed guardrail.



