

16 x 20 Stage Package

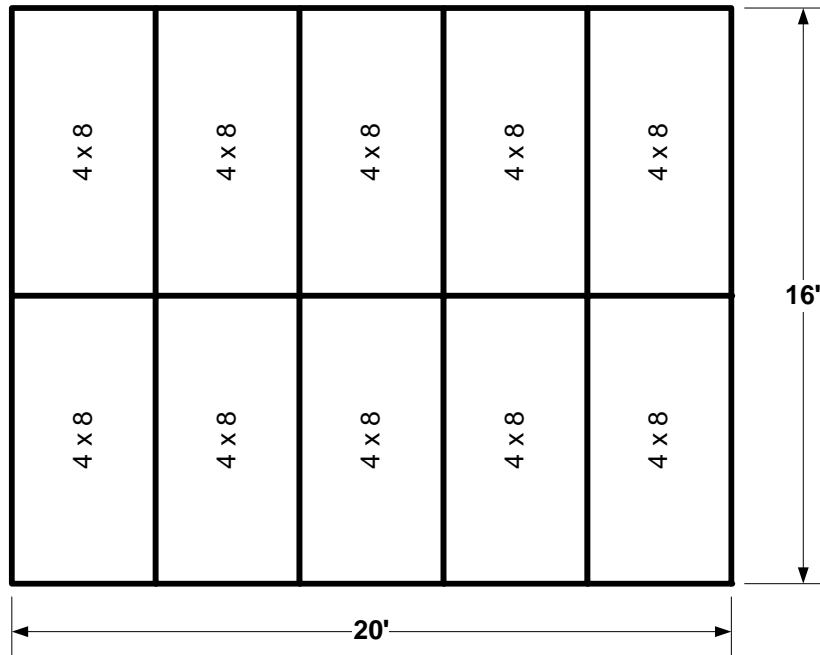

Quik Stage portable stage packages are available in many sizes and heights. The stage package shown above includes the following components, which are listed in the table below. Each package is available in the five standard heights listed below. These packages are designed to be used as a guide to help you select the stage that will best fit your specific needs and you can add or subtract any or all of the components. Contact your Quik Stage staging specialist at toll free 1-877-783-7373 or sales@quikstage.com for a quick no obligation price quote. In addition to these stage packages, Quik stage portable staging has the flexibility to be used in a wide variety of sizes and configurations.

Leg Height Inches	Legs Needed	Stage Decks		2-Leg Leg Clamp	4-Leg Leg Clamp	Stair Unit	Feet of Skirting	Deck Surfaces Available
		4 x 8	4 x 4					
8	60	10	0	0	0	0	52	Unfinished Plywood Ground Pepper Carpet Polyvinyl Quad Ripple Weather Resistant
16						1		
24				10	4			
32								
40								

- A stair unit is not needed with 8 inch legs.
- Leg Clamps are recommended at leg heights of 32 & 40 inches high for maximum stability.
- Skirting in the package is figured for 3 sides only not including the back of the stage.
- Quik Stage portable staging and accessories are available in many other sizes and heights. If you don't see a package you like, we can quote you any size stage or height you need.