



**QUIK STAGE**  
ELEVATING YOUR EVENTS

# napkin folds

## Surprise Package

1. With right side of napkin down, fold in half diagonally. 2. Fold corners up to top corner, forming a square. 3. Turn napkin over (closed portion on points down). 4. Fold lower corner up to top, forming a triangle. 5. Fold left and right corners diagonally across center so they extend beyond edge of triangle; turn napkin over. 6. Spread flaps to side and open slightly. 7. Fold down two top layers of inner diamond.

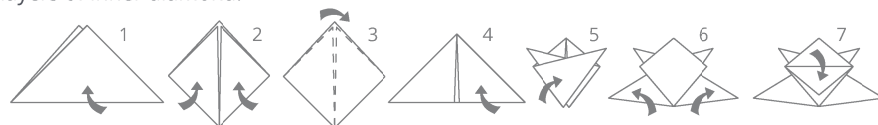

## Rose

1. Fold all four corners of the napkin to center. 2. Fold newly formed corners to center. 3. Turn napkin over and fold all four corners to the center. 4. Holding center firmly, reach under each corner and pull up flaps to form petals; reach between petals and pull flaps from the underneath.

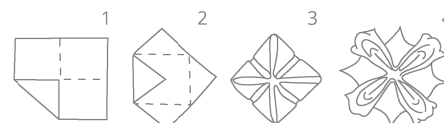

## Bird of Paradise

1. Fold napkin in half and in half again. 2. Fold in half diagonally with points on the top and facing up. 3. Fold left and right sides down along center line, turning extended points under. 4. Fold in half on long dimension with edges facing out. 5. Pull up points and arrange on fabric surface.



## Crown

1. Fold napkin diagonally in half. 2. Fold corners to meet at the top point. 3. Fold bottom point 2/3 of the way to the top and then fold back onto itself. 4. Turn napkin over and bring corners together, tucking one into the other. 5. Pull the two top corners down to make crown; open base of fold and stand upright.

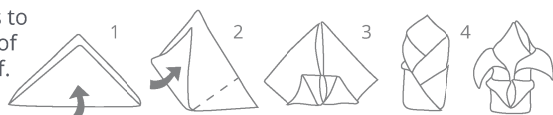

## Lady Windermere's Fan

1. Fold napkin in half. 2. Starting with bottom, accordion pleat 2/3 of the way up. 3. Fold in half with pleating on the outside. 4. Fold upper right corner diagonally down to folded base of pleats and turn under edge. 5. Place on table and release pleats to form fan.

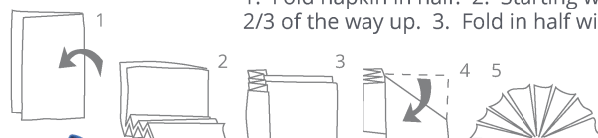

## Pyramid

1. Fold napkin in half diagonally. 2. Fold corners to meet at the top point. 3. Turn napkin over and fold in half. 4. Pick up center and stand on base of triangle.

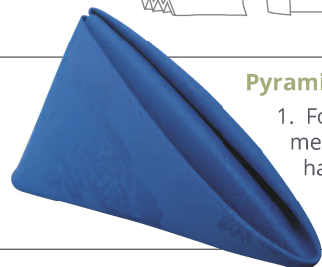
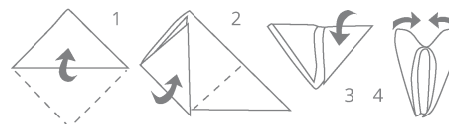

## Pinwheel

1. Fold napkin in half. 2. Fold in half again, forming a square. 3. Fold top right and bottom left corners to midpoint. 4. Fold upper left and lower right corners to back midpoint. 5. Fold two opposing corners to midpoint; turn napkin over. 6. Fold left and right corners to midpoint. 7. Hold midpoint firmly and pull out open layers of most recently formed triangles; turn over. 8. Holding midpoint, pull out open layers of triangles. (see Nouveau Ultraspun for photo)

