

7. LOWERING OF THE LOAD (reversing the lifting procedure)

Before releasing anything, ensure that the winch cable is tight.

Release the locking pins and knobs in a reverse sequence as in the lifting procedure.

Rotating the winch handle counter-clockwise lowers the load. The winch is auto-braking. Stopping the handle rotation stops the lowering.

Watch the load carefully to avoid touching or getting hooked on obstacles.

8. Transport Position

The steel cable must be correctly and completely rolled up to avoid any crushing of the fibres.

The stand can be transported in a vertical or horizontal position.

9. Sparepart List

Item	Part Name	Description	Sizes	Qty
1	Adjustable Leg Stump Sleeve	SPLegStumpSleeve	Rect. 30x30x2 70mm	1
2	Bottom fixed Collar	SPBottomCollar	Tube 70x4 60mm	1
3	Deviation Pulley	SPDevPulleyM2	PTFE 21.5x8x8	1
4	Extendable Leg Stump	SPLegStump	Rect. 25x25x1.5 350mm	1
5	Fixed Length Leg	SP3Legs	Rect. 30x30x2 1130mm	1
6	Fixed Length Leg	SP3Legs	Rect. 30x30x2 1200mm	2
7	Hex Nut	Hexagon Nut ISO 4032 - M10 - W - N	M10	2
8	Hex Nut	Hexagon Nut ISO 4032 - M12 - W - N	M12	3
9	Hex Nut	Hexagon Nut ISO 4034 - M12 - N	M12	3
10	Hex Nut	Hexagon Nut ISO 4034 - M8 - N	M8	1
11	Housing with Notch	SpringPinHousing	M12	4
12	Lock Washer	Spring washer DIN 128 - A6	M6	2
13	Mast 2 Pulley	SPM2Pulley	PTFE 40x22x8	1
14	Mobil Tech Knob M10	MTKnob	M10x20	1
15	Mobil Tech Knob M10	MTKnob	M10x30	3
16	Nylon Cable Pulley	SPPulleys	Loop Pulley PTFE 40x24x8	1
17	Nylon Cable Pulley	SPPulleys	Winch Pulley PTFE	1
18	Nylon Pad	SPPVCPad	PTFE 100x30x8	1
19	Pin 8-6mm	Pin 35-21 8-6	Pin Dia 8/6 x 35	4
20	Prevailing Torque Nut	DIN EN ISO 7040 - M10 - N	M10	3
21	Prevailing Torque Nut	DIN EN ISO 7040 - M12 - N	M12	1
22	Prevailing Torque Nut	DIN EN ISO 7040 - M8 - N	M8	11
23	Pull Ring	SpringPinRing	30x2mm	4
24	Sliding Collar	SPTopCollar	Tube 70x4 60mm	1
25	Socket Countersunk Head Screw	DIN 7991 - M8 x 35 --- 26.8N	M8x35	1
26	Socket Head Screw	DIN 912 M10 x 20 --- 20C	M10x20	2
27	Socket Head Screw	DIN 912 M10 x 80 --- 80C	M10x80	1
28	Socket Head Screw	DIN 912 M12 x 50 --- 50C	M12x50	1
29	Socket Head Screw	DIN 912 M6 x 10 --- 10C	M6x10	2
30	Socket Head Screw	DIN 912 M8 x 45 --- 45C	M8x45	2
31	Socket Head Screw	DIN 912 M8 x 50 --- 50C	M8x50	9
32	Spring 6mm	Ring Dia 6	16x7x0.8	4
33	SPTek2000 Mast 2	SPMast2	Tube Rect. 40x40x1.5 1500mm	1
34	SPTek4000 Leg Crossbrace	SPBrace	Flat 30x4 495mm	6
35	SpTek4000 Mast 1	SPMast1	Round Tube 60x2 1500mm	1
36	SPTek4000 Mast 3	SPMast3	Tube 35x2 1600mm	1
37	Washer	Washer ISO 7090 - 10	10.5x20	2
38	Manual Cable Winch	Winch Body 6AF	Winch Body with Drum	1
39	Manual Cable Winch	Handle 6AF	Metal Handle	1
40	Manual Cable Winch	WinchGrip	Rubber Handle Grip	1

10. Sparepart display

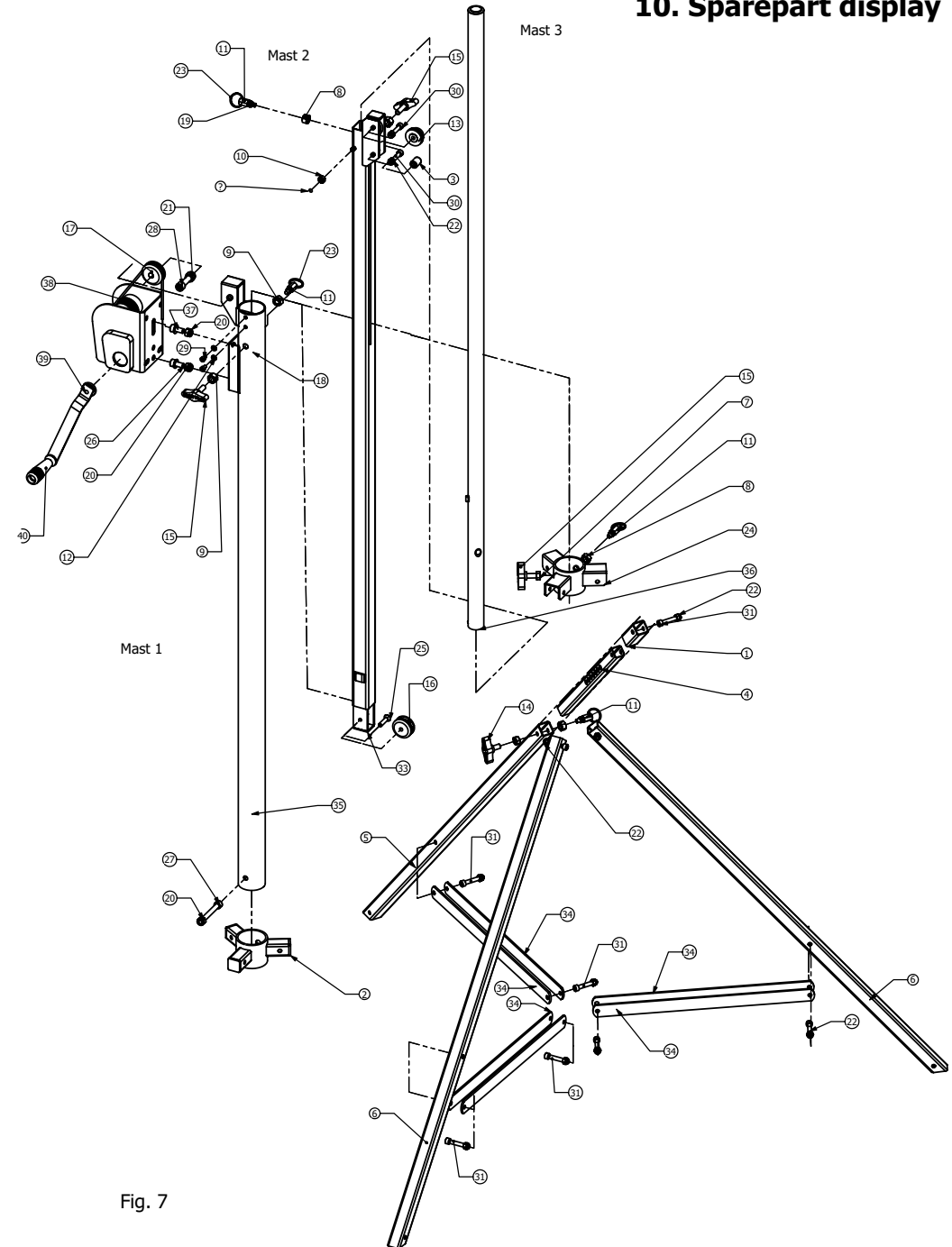

Fig. 7